

Compact Log-periodic Array

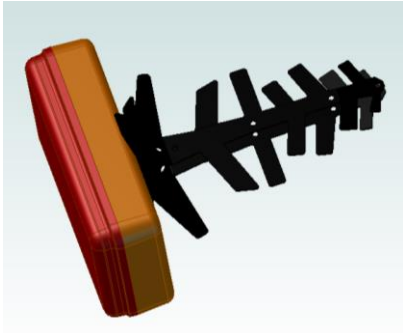

Preliminary Specification

Jan 04, 2017



Features

- 650 – 4500 MHz
- 8.5 dBi Peak Gain
- 20 (X) 13 (Y) 18 (Z) cm (Antenna only- enclosure not included)
- Designed to attach directly to electronic enclosure.

Electrical Performance

